

AIRSPACE/APPROACH PROFILES DRAWING

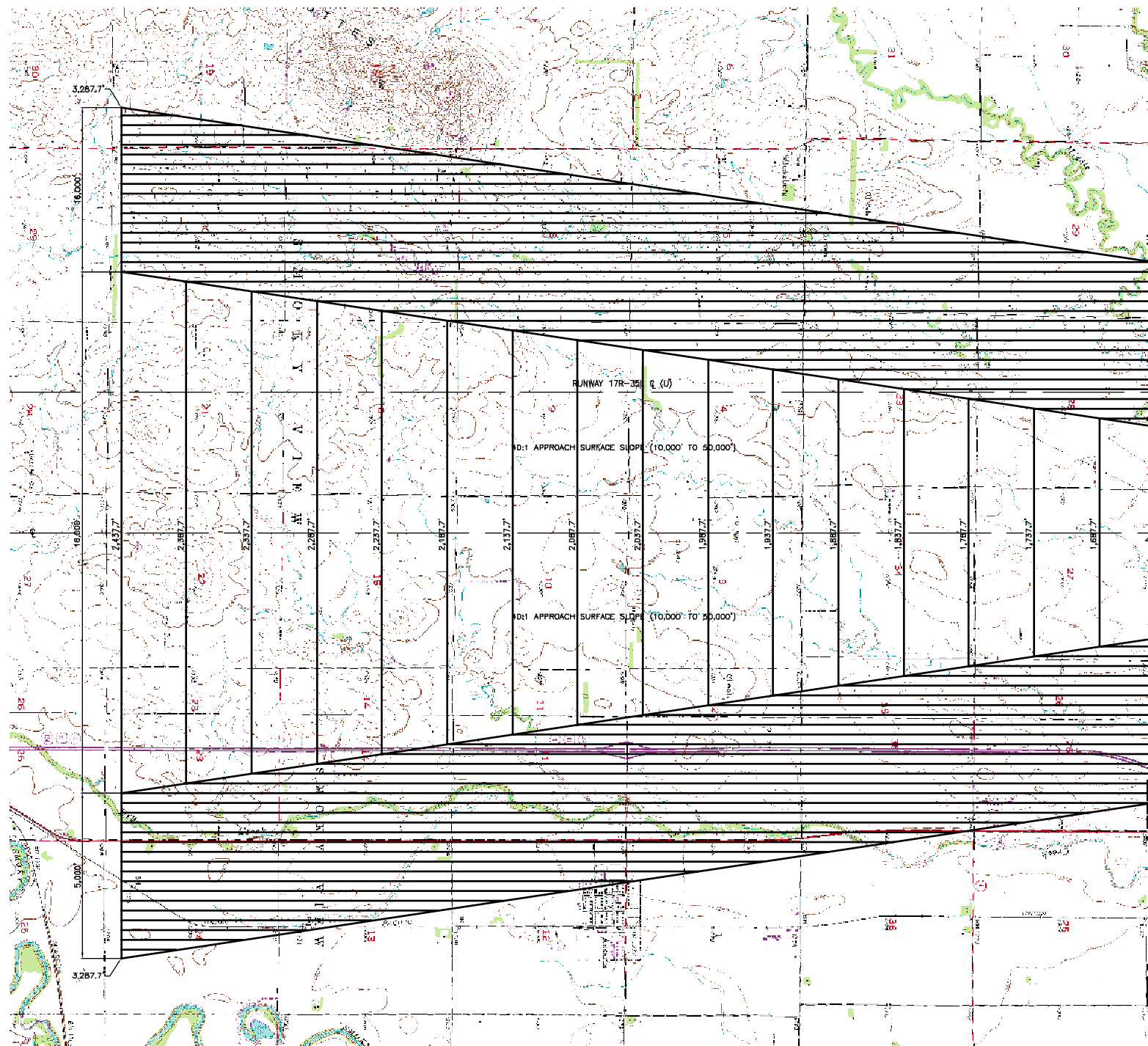

MATCH LINE - APPROACH SLOPE CONTINUES (SEE SHEET F3)

RUNWAY 17- INNER 10,000' PORTION OF THE PRECISION APPROACH SURFACE

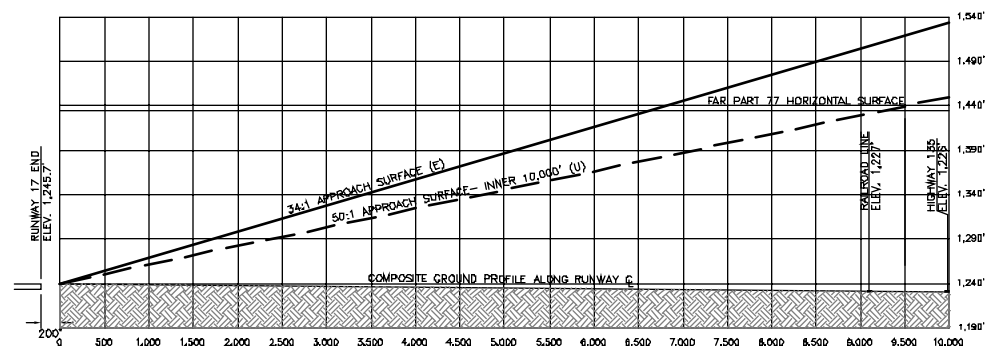

APPROACH PROFILE
SCALE IN FEET
HORIZONTAL SCALE 1" = 1000'
VERTICAL SCALE 1" = 100'

RUNWAY 35- INNER 10,000' PORTION OF THE PRECISION APPROACH SURFACE

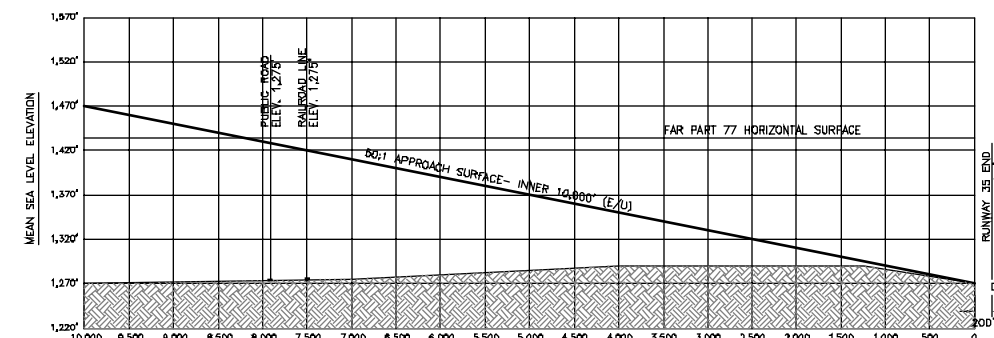

APPROACH PROFILE
SCALE IN FEET
HORIZONTAL SCALE 1" = 1000'
VERTICAL SCALE 1" = 100'

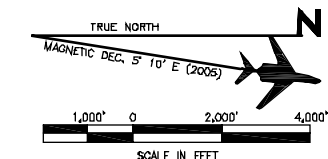

FAR PART 77 OBSTRUCTION TABLE

THERE ARE NO EXISTING ENCROACHMENTS OF THE FAR PART 77 AIRSPACE SURFACES. ELEVATIONS BASED ON CURRENT USGS MAPS, FAA CENTRAL REGION OBSTRUCTION INFORMATION DATABASE (09/05). REFER TO THE PLAN VIEW OF THE INNER PORTION APPROACH SURFACE DRAWING FOR CLOSE-IN/ADJACENT AIRPORT OBSTRUCTIONS. ALL OBSTRUCTIONS SHOULD REMAIN CLEAR WITHIN THE PRIMARY, TRANSITIONAL, AND APPROACH SURFACES IN ACCORDANCE WITH FAR PART 77 FOR ALL RUNWAYS.

**SALINA AIRPORT AUTHORITY (SAA)
SALINA, KANSAS**

**SALINA MUNICIPAL AIRPORT
AIRSPACE/APPROACH
PROFILES DRAWING**

JOB NO. 2004-0310.01	DESIGNED BY: MAW	DATE: 06/05/06	REVISIONS:
DRAWING NO. FIVE	DRAWN BY: MAW	DATE: 06/05/06	
SCALE AS SHOWN	CHECKED BY: BCW	DATE: 06/05/06	
SHEET: 5	 403 E. 104TH ST., SUITE 400, KANSAS CITY, MO 64151-3451 800.748.6278		
OF 20			

KANSAS • MISSOURI • TEXAS • COLORADO • WASHINGTON • OKLAHOMA