

NORTHERN TERMINAL AREA/INDUSTRIAL/SLN AVIATION SERVICE CENTER DRAWING

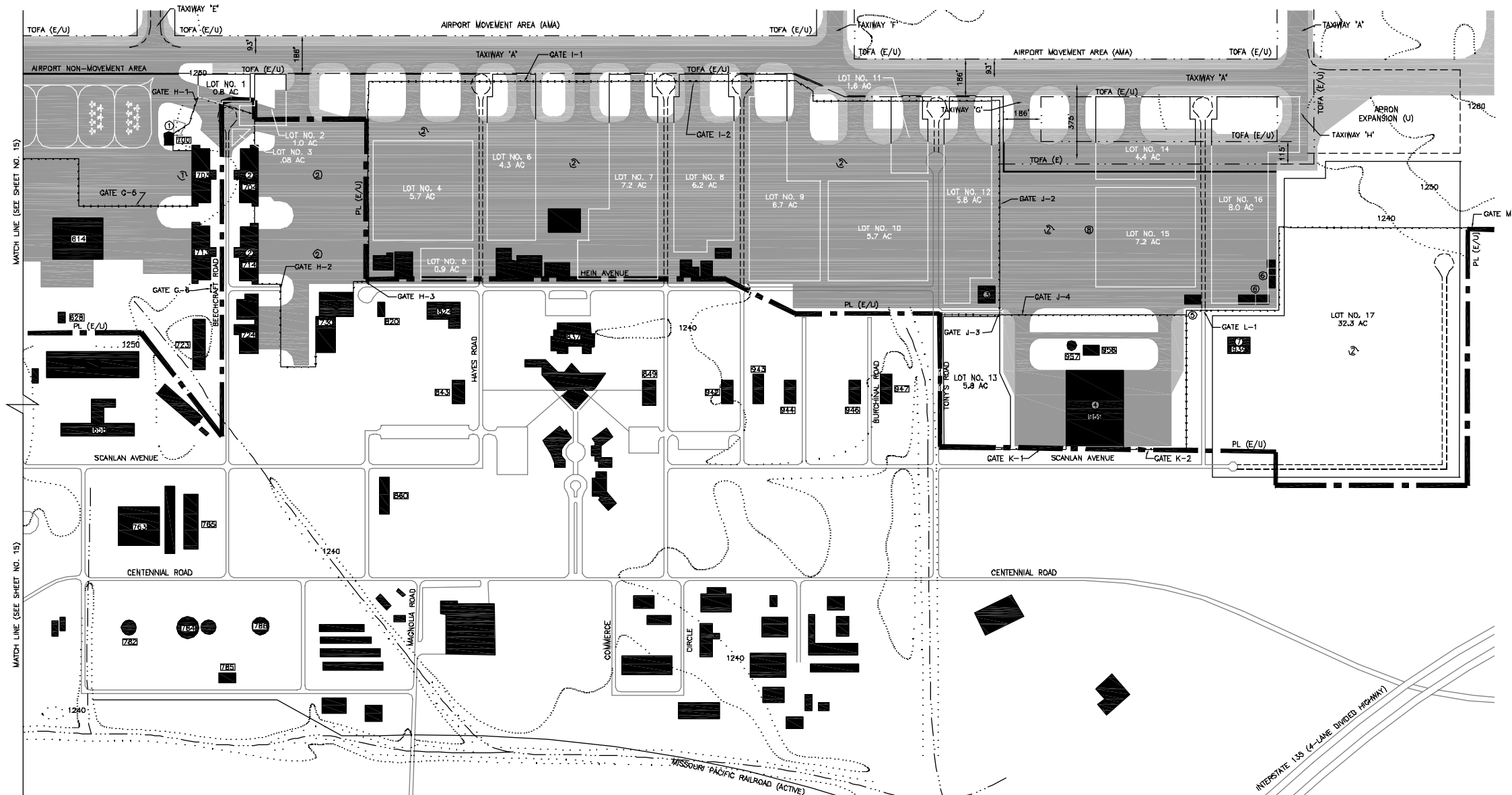

EXISTING BUILDINGS AND FACILITIES			
EXISTING			
NO.	DESCRIPTION	TOP ELEVATION	DISPOSITION
①	FIXED BASED OPERATOR BUILDING	---	RETAIN
②	KSU - SALINA CLEAR SPAN HANGAR/AIRCRAFT TIE-DOWN AREA	---	RETAIN
③	PRIVATE OWNED CLEAR SPAN HANGAR	---	RETAIN
④	RAYTHEON/BEECH FLIGHT OPERATIONS/MANUFACTURING FACILITY	---	RETAIN
⑤	KANSAS WING - CIVIL AIR PATROL INDIVIDUAL T-HANGAR	---	RETAIN
⑥	KANSAS HIGHWAY PATROL (KHP) INDIVIDUAL COMMON HANGAR(S)	---	RETAIN
⑦	KANSAS WING - CIVIL AIR PATROL ADMINISTRATIVE BUILDING	---	RETAIN
⑧	NON-PART 139 AIRCRAFT PARKING APRON/TIE-DOWN AREA	---	RETAIN
ULTIMATE BUILDINGS AND FACILITIES			
ULTIMATE			
NO.	DESCRIPTION	TOP ELEVATION	DISPOSITION
①	RAYTHEON AIRCRAFT HANGAR #703	---	ACQUIRE
②	PROPOSED SLN AVIATION SERVICE CENTER DEVELOPMENT AREA	---	DEVELOP

ALTHOUGH NOT BELIEVED TO BE AN ISSUE, A SURVEY IS RECOMMENDED WITHIN THE SHORT TERM DEVELOPMENT PERIOD (0-5 YEAR) TO DETERMINE THE TOP ELEVATION OF THE STRUCTURES WITHIN THE AIRPORT INDUSTRIAL CENTER TO ENSURE COMPLIANCE WITH THE FAR PART 77 AIRSPACE SURFACES.

TERMINAL AREA LEGEND		
EXISTING	ULTIMATE	FACILITIES
—	—	BUILDINGS/STRUCTURES
PL (E)	PL (U)	AIRPORT PROPERTY LINE
TOFA (E)	TOFA (U)	TAXIWAY/TAXILANE RUNWAY OBJECT FREE AREA
X	-XX-	FENCING
—	—	GROUND CONTOUR (USGS MAP)
—	—	PAVED ROADWAY
—	—	CONTROLLED AUTO ACCESS GATE
TOFA (E)	TOFA (U)	TAXIWAY/TAXILANE OBJECT FREE AREA (TOFA)
—	—	SECTION CORNER
—	—	AIRCRAFT HOLD MARKINGS
—	—	CREEK/INTERMITTENT DRAINAGE DITCH

TERMINAL AREA DESIGN/SEPARATION CRITERIA			
ITEM	AIRPLANE DESIGN GROUP		
	I	II	III
TAXIWAY WIDTH	25'	35'	50'
TAXIWAY CENTERLINE TO:			
PARALLEL TAXIWAY/TAXILANE CENTERLINE	89'	105'	152'
FIXED OR MOVABLE OBJECT	44.5'	85.5'	83'
TAXILANE CENTERLINE TO:			
PARALLEL TAXILANE CENTERLINE	64'	97'	140'
FIXED OR MOVABLE OBJECT	39.5'	57.5'	81'
TAXIWAY SAFETY AREA WIDTH	49'	79'	118'
TAXIWAY OBJECT FREE AREA WIDTH	89'	131'	186'
TAXILANE OBJECT FREE AREA WIDTH	79'	115'	162'

BASED ON FAA ADVISORY CIRCULAR 150/5300-13, CHANGE #8

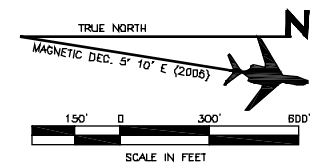

SALINA AIRPORT AUTHORITY (SAA)
SALINA, KANSAS
SALINA MUNICIPAL AIRPORT
NORTHERN TERMINAL AREA/
INDUSTRIAL/SLN AVIATION
SERVICE CENTER DRAWING

KSJ NO. 2004-0310.01	DESIGNED BY: MAW	DATE: 06/05/06	REVISIONS:
DRAWING NO. SIXTEEN	DRAWN BY: MAW	DATE: 06/05/06	
SCALE AS SHOWN	CHECKED BY: BCW	DATE: 06/05/06	
SHEET: 18			
OF 20			