

RUNWAY 35 INNER PORTION OF THE APPROACH SURFACE DRAWING

RUNWAY 35 END PLAN VIEW

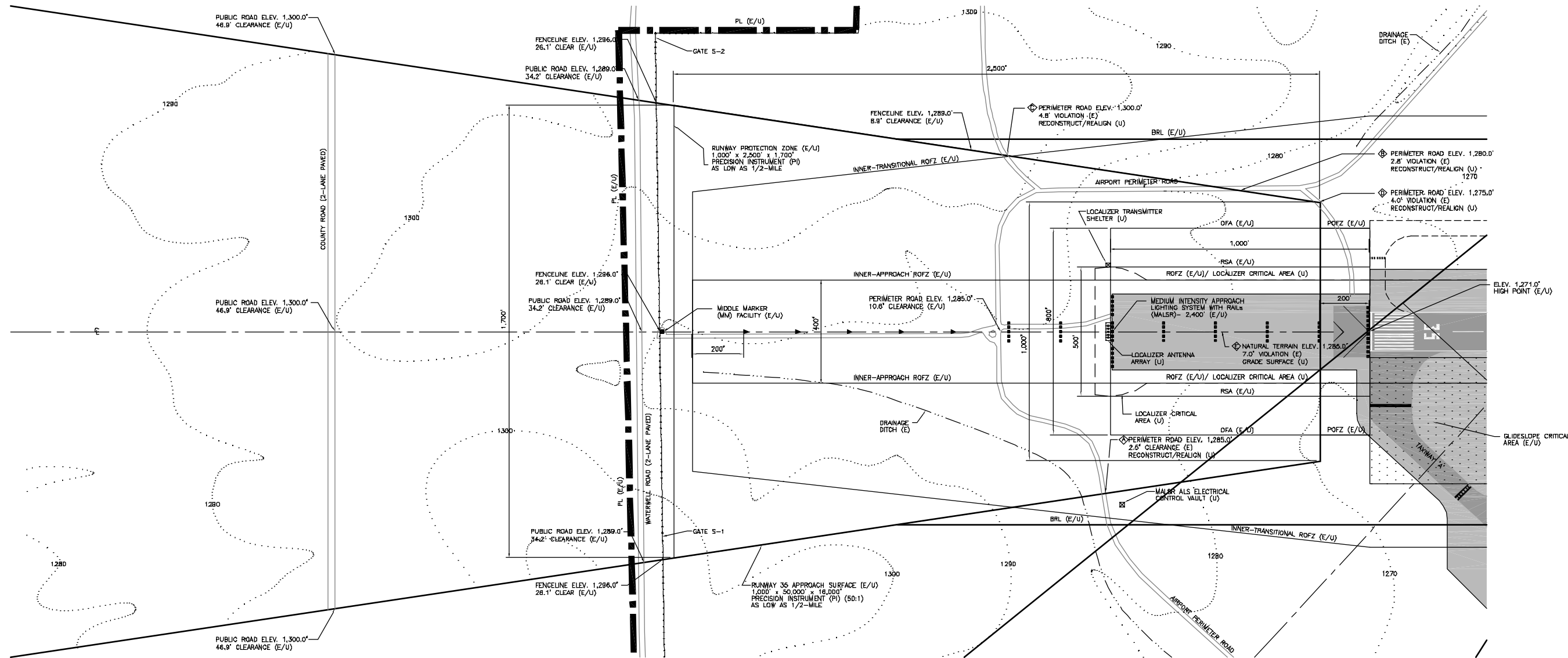

RUNWAY 35 END PROFILE VIEW

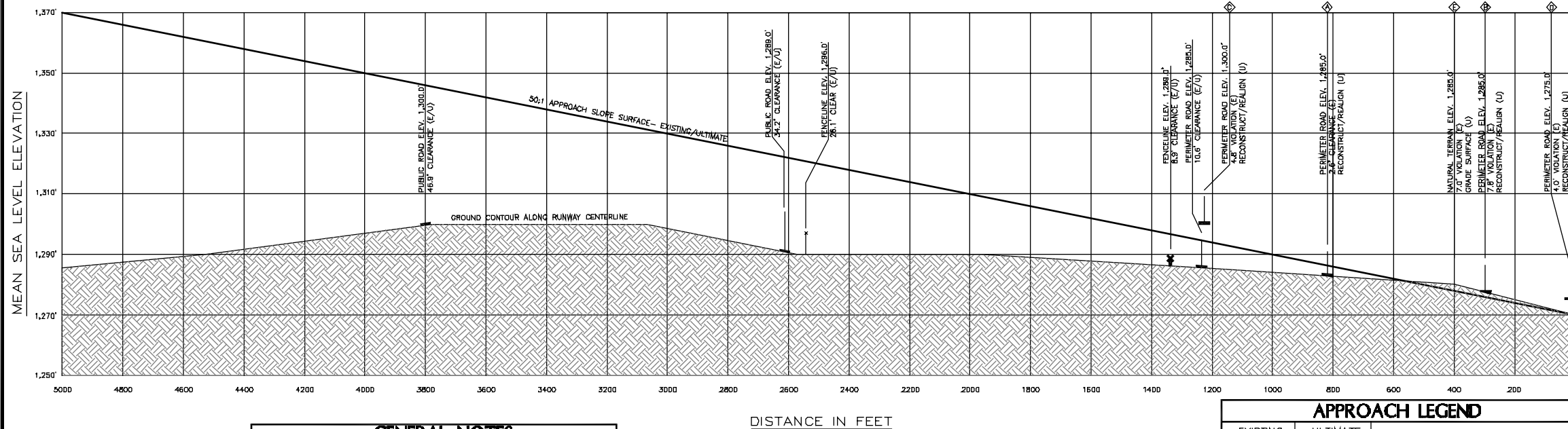

GENERAL NOTES
 PROFILE VIEW DEPICTS THE MINIMUM FAR PART 77 CLEARANCES FOR RAILROADS, 23.0'; HIGHWAYS, 17.0'; PUBLIC ROADS, 15.0'; AND PRIVATE ROADS, 10.0'

EXISTING		ULTIMATE		
PL (E)	PL (U)	PL (E)	PL (U)	FACILITIES
BRL (E)	BRL (U)	BRL (E)	BRL (U)	AIRPORT PROPERTY LINE
E				BUILDING RESTRICTION LINE (BRL)
X				POWERLINE/POLE
				FENCING

FAR PART 77 OBSTRUCTION TABLE

ITEM	DESCRIPTION	VIOLATION (E)	CLEAR (U)	MITIGATION
⬠	PERIMETER ROAD	2.8'	-	RECONSTRUCT/REALIGN
⬠	PERIMETER ROAD	7.9'	-	RECONSTRUCT/REALIGN
⬠	PERIMETER ROAD	4.8'	-	RECONSTRUCT/REALIGN
⬠	PERIMETER ROAD	4.0'	-	RECONSTRUCT/REALIGN
⬠	NATURAL TERRAIN	7.0'	-	GRADE SURFACE

ELEVATIONS ESTIMATED FROM USGS MAP INFORMATION AND PREVIOUS AIRPORT MASTER PLAN UPDATE/ ALP UPDATE SURVEY INFORMATION (NOVEMBER 1992).
 NO RUNWAY OBSTACLE FREE ZONE (ROFZ) OBJECT PENETRATIONS
 NO THRESHOLD STOPPING SURFACE (TSS) OBJECT PENETRATIONS
 AN INSTRUMENT APPROACH PROCEDURE (IAP) 405 AERONAUTICAL SURVEY FOR RUNWAY 17-35 WAS CONDUCTED IN AUGUST AND SEPTEMBER 2005. RESULTS INDICATE THAT TERRAIN ENDOACHES UPON THE RUNWAY 35 PART 77 APPROACH SURFACE. THE RECOMMENDED MITIGATIVE COURSE OF ACTION TO REMEDY THIS CONDITION IS TO GRADE THE SURFACE.

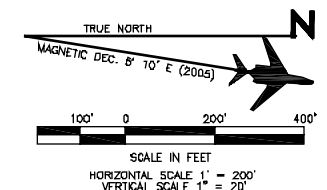

SALINA AIRPORT AUTHORITY (SAA)
SALINA, KANSAS
SALINA MUNICIPAL AIRPORT
RUNWAY 35 INNER PORTION OF
THE APPROACH SURFACE DRAWING

JOB NO. 2004-0310.01	DESIGNED BY: MAW	DATE: 06/05/06	REVISIONS:
DRAWING NO. EIGHT	DRAWN BY: MAW	DATE: 06/05/06	
SCALE AS SHOWN	CHECKED BY: BCW	DATE: 06/05/06	
SHEET: 8	BUCHER, WILLIS & RATLIFF		
OF 20	105 E. 104TH ST., SUITE 200, WARDEN, KS 66411-3451 866.748.2718		