

2012 A Kneubuhl Court

Salina, Kansas



Salina Airport Authority / Hangar Building 506-2

As exclusive agents, we are pleased to offer the following space for lease:



- ◆ 4,447 SF hangar building
- ◆ 453 SF office space
- ◆ Data/network cable infrastructure installed
- ◆ Phone system in place
- ◆ Doors measure 56 feet wide and 16 feet high
- ◆ Single and three phase electric service; 240/120v, 3 phase
- ◆ Local and state economic development incentives
- ◆ Easy access to I-135 and I-70
- ◆ \$3.30 - \$4.00/SF / year (\$1,345 - \$1,630 / month)

Shelli Swanson, C.M. 785.827.3914 shellis@salair.org
www.salinaairport.com

SALINAAirport
Authority

2012 A Kneubuhl Court

Salina, Kansas

Floor Plan

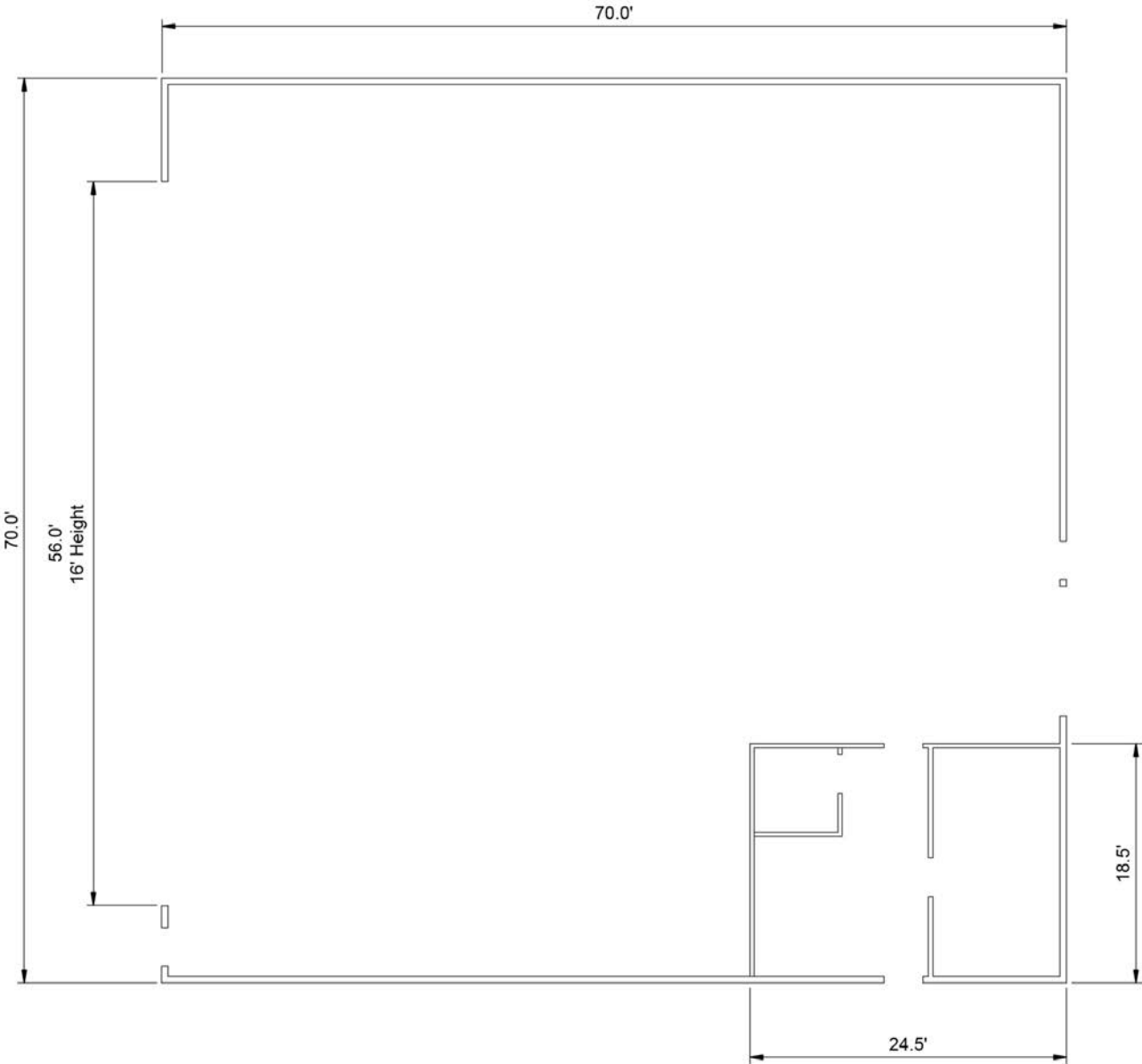

Shelli Swanson, C.M. 785.827.3914 shellis@salair.org
www.salinaairport.com